

1	5	8
2	6	9
3	7	10 11
4		12

Posizione Componenti nel Box / Devices Position in the Box

20M3690C1010 n° 4	20M3600C1210 n° 4	20M3690C1210 n° 4
20M3640C1010 n° 2	20M3600C1010 n° 4	20M3640C1210 n° 2
20M3690C0808 n° 3	20M3600C0808 n° 4	20M3690 C0606 N° 3
20M3640C0808 n° 2		20M3600 C0606 N° 4
		20M3640C0606 n° 2

Posizione Componenti nel Box / Devices Position in the Box

# BOX KLIMAKLAMP® UTENSILI E RACCORDI

## (Versione PREMIUM)

### KK-BOX-PRM-000



Contenuto BOX		Q.tà (pz)
Descrizione	Codice	
Tagliatubi a rullino	P-CUT-000	1
Sbavatore per tubi rigidi	SBV-001	1
Pinza chiusura fascette standard (Basic)	PLIERS-001-01	1
Taglierina per tubi in gomma (Basic)	H-CUT-001	1
Kit di ricambi di servizio (Professional)	SERV-KIT-000	1
Raccordo KlimaKlamp® dritto 06	20M3600C0606	4
Raccordo KlimaKlamp® dritto 08	20M3600C0808	4
Raccordo KlimaKlamp® dritto 10	20M3600C1010	4
Raccordo KlimaKlamp® dritto 12	20M3600C1210	4
Raccordo KlimaKlamp® curva 45° - 06	20M3640C0606	2
Raccordo KlimaKlamp® curva 45° - 08	20M3640C0808	2
Raccordo KlimaKlamp® curva 45° - 10	20M3640C1010	2
Raccordo KlimaKlamp® curva 45° - 12	20M3640C1210	2
Raccordo KlimaKlamp® curva 90° - 06	20M3690C0606	3
Raccordo KlimaKlamp® curva 90° - 08	20M3690C0808	3
Raccordo KlimaKlamp® curva 90° - 10	20M3690C1010	4
Raccordo KlimaKlamp® curva 90° - 12	20M3690C1210	4
Tubo flessibile in gomma 06 (2 m)	FG100DN08-02000	2
Tubo flessibile in gomma 08 (2 m)	FG100DN10-02000	2
Tubo flessibile in gomma 10 (2 m)	FG100DN13-02000	2
Tubo flessibile in gomma 12 (2 m)	FG100DN16-02000	2

[www.flexingroup.com](http://www.flexingroup.com)  
music: www.bensound.com

**KLIMAKLAMP®**

**FLEXIN** GROUP  
All Rights Reserved

Protetto da Modello di Utilità Depositato  
Protected By Utility Model Pending

MADE IN ITALY

MADE IN ITALY





PD (mm)	HD			Codice Raccordo Fitting Code
	Dash Tubo Hose Dash	Size Tubo [mm] Hose Size [mm]	Size Tubo [in] Hose Size [in]	
9.5÷10	06	7,5 ÷ 8,5	5/16"	<b>20M3600C0606</b>
<b>12÷12.7</b>	08	<b>9,5 ÷ 10,5</b>	<b>13/32"</b>	<b>20M3600C0808</b>
15.8÷16	10	12,5 - 13,5	1/2"	<b>20M3600C1010</b>
15.8÷16	12	15,5 ÷16,5	5/8"	<b>20M3600C1210</b>

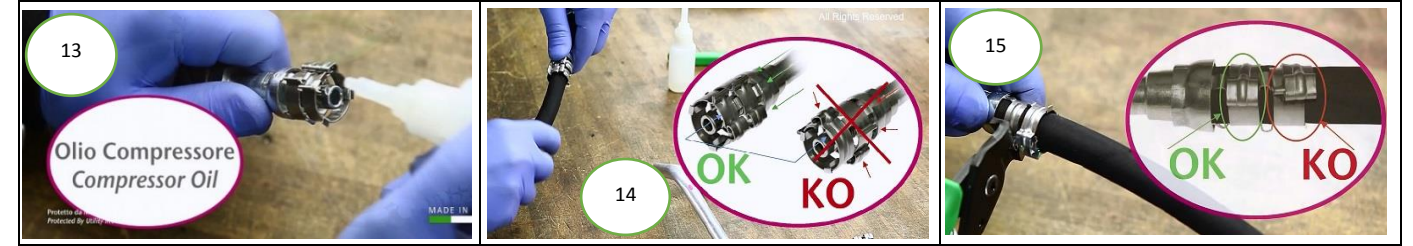
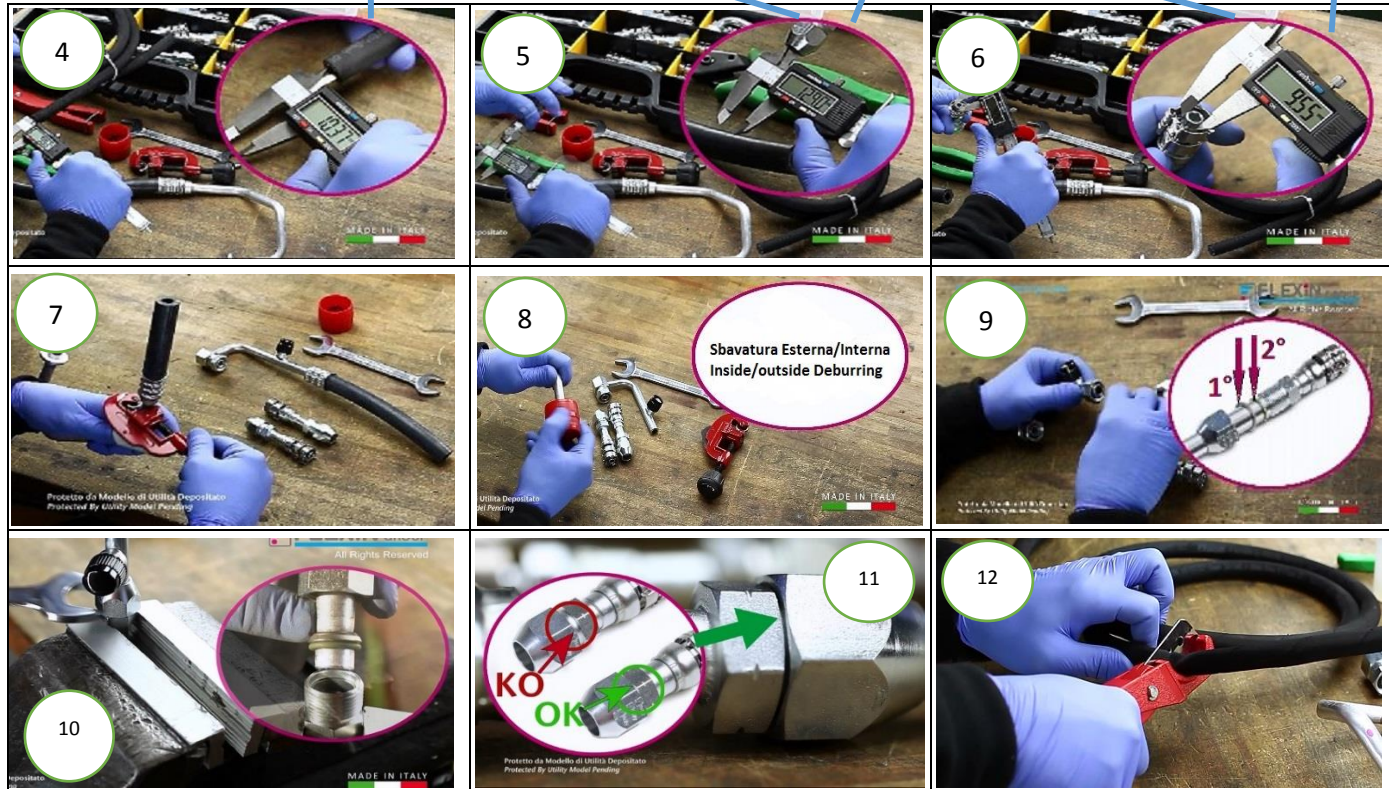
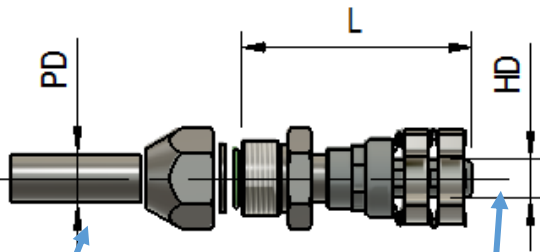

## Disassembling:

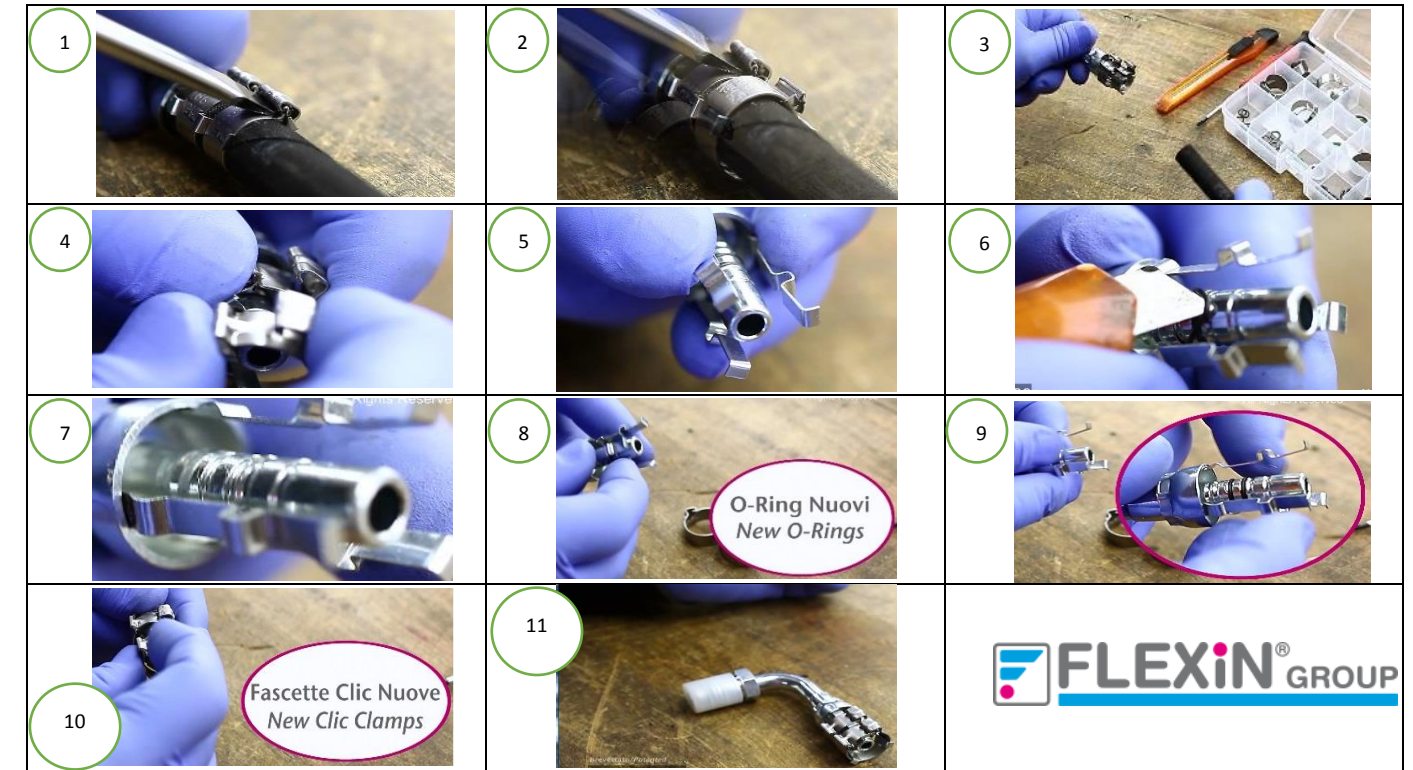

Per il Tutorial Completo Contattare: [info@flexingroup.com](mailto:info@flexingroup.com)  
 For a Complete Tutorial Please Contact: [info@flexingroup.com](mailto:info@flexingroup.com)