

www.flexingroup.com  
music: www.bensound.com



**FLEXiN**® GROUP  
All Rights Reserved

**KLIMAKLAMP**®

MADE IN ITALY

Protetto da Modello di Utilità Depositato  
Protected By Utility Model Pending

## MANUALE UTENTI BOX KLIMAKLAMP®: UTENSILI E RACCORDI (Versione TEST) KK-BOX-TST-000



| Contenuto BOX                            |                 | Q.tà (pz) |
|--|-----------------|-----------|
| Descrizione                              | Codice          |           |
| Tagliatubi a rullino                     | P-CUT-000       | 1         |
| Sbavatore per tubi rigidi                | SBV-001         | 1         |
| Pinza chiusura fascette standard (Basic) | PLIERS-001-01   | 1         |
| Taglierina per tubi in gomma (Basic)     | H-CUT-001       | 1         |
| Raccordo KlimaKlamp® dritto 06           | 20M3600C0606    | 2         |
| Raccordo KlimaKlamp® dritto 08           | 20M3600C0808    | 2         |
| Raccordo KlimaKlamp® dritto 10           | 20M3600C1010    | 2         |
| Tubo flessibile in gomma 06 (1 m)        | FG100DN08-01000 | 1         |
| Tubo flessibile in gomma 08 (1 m)        | FG100DN10-01000 | 1         |
| Tubo flessibile in gomma 10 (1 m)        | FG100DN13-01000 | 1         |

MADE IN ITALY



| PD (mm) | HD                     |                                  | Codice Raccordo<br>Fitting Code |                                  |
|---------|------------------------|----------------------------------|---------------------------------|----------------------------------|
|         | Dash Tubo<br>Hose Dash | Size Tubo [mm]<br>Hose Size [mm] |                                 | Size Tubo [in]<br>Hose Size [in] |
| 9.5÷10  | 06                     | 7,5 ÷ 8,5                        | 5/16"                           | 20M3600C0606                     |
| 12÷12.7 | 08                     | 9,5 ÷ 10,5                       | 13/32"                          | 20M3600C0808                     |
| 15.8÷16 | 10                     | 12,5 - 13,5                      | 1/2"                            | 20M3600C1010                     |
| 15.8÷16 | 12                     | 15,5 ÷16,5                       | 5/8"                            | 20M3600C1210                     |

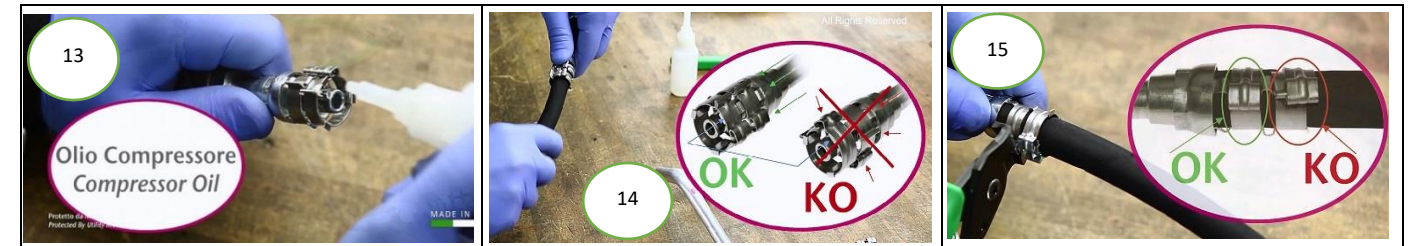
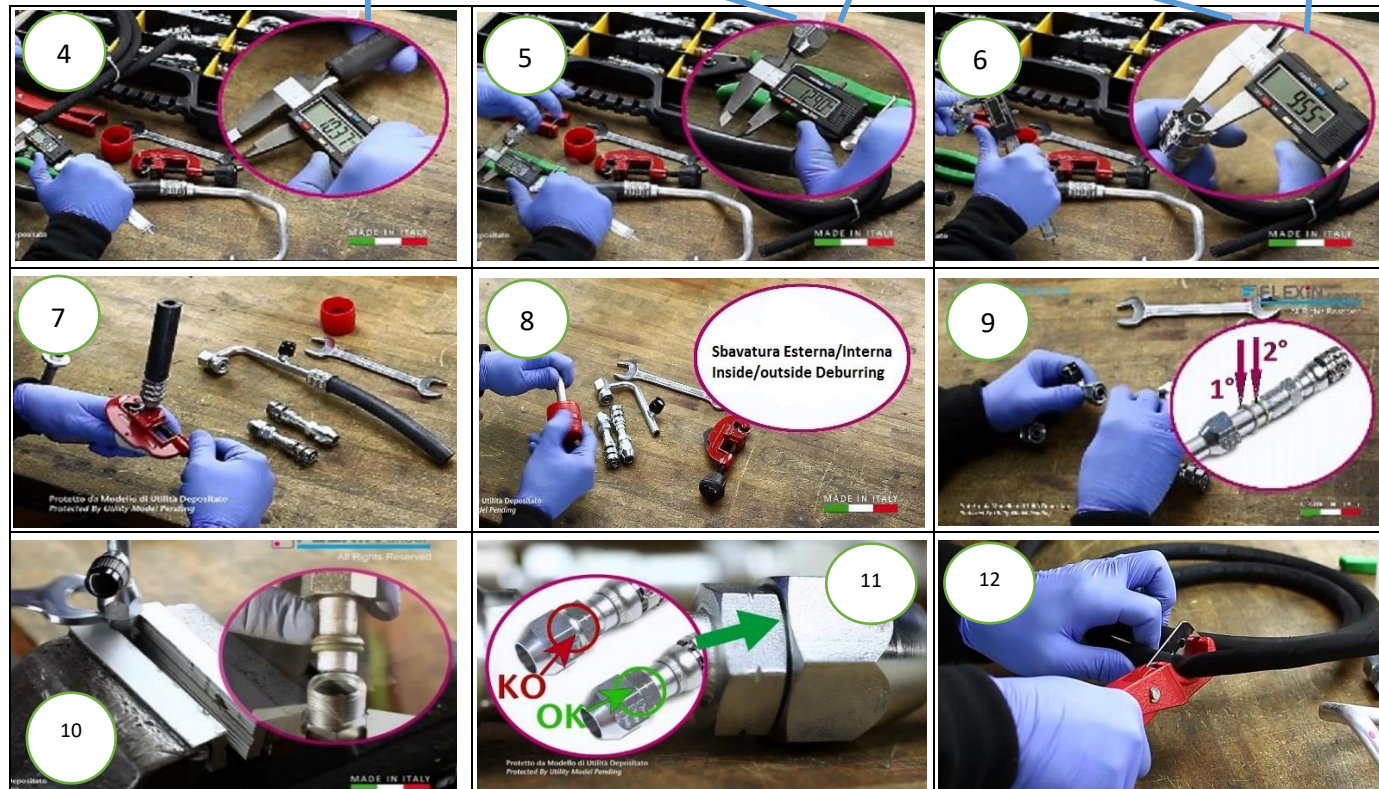
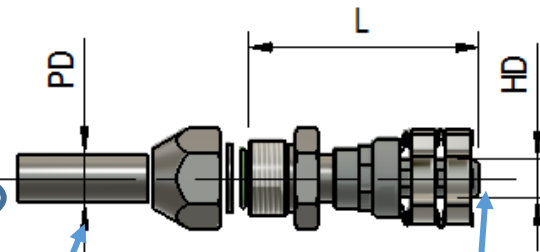

## Disassembling:

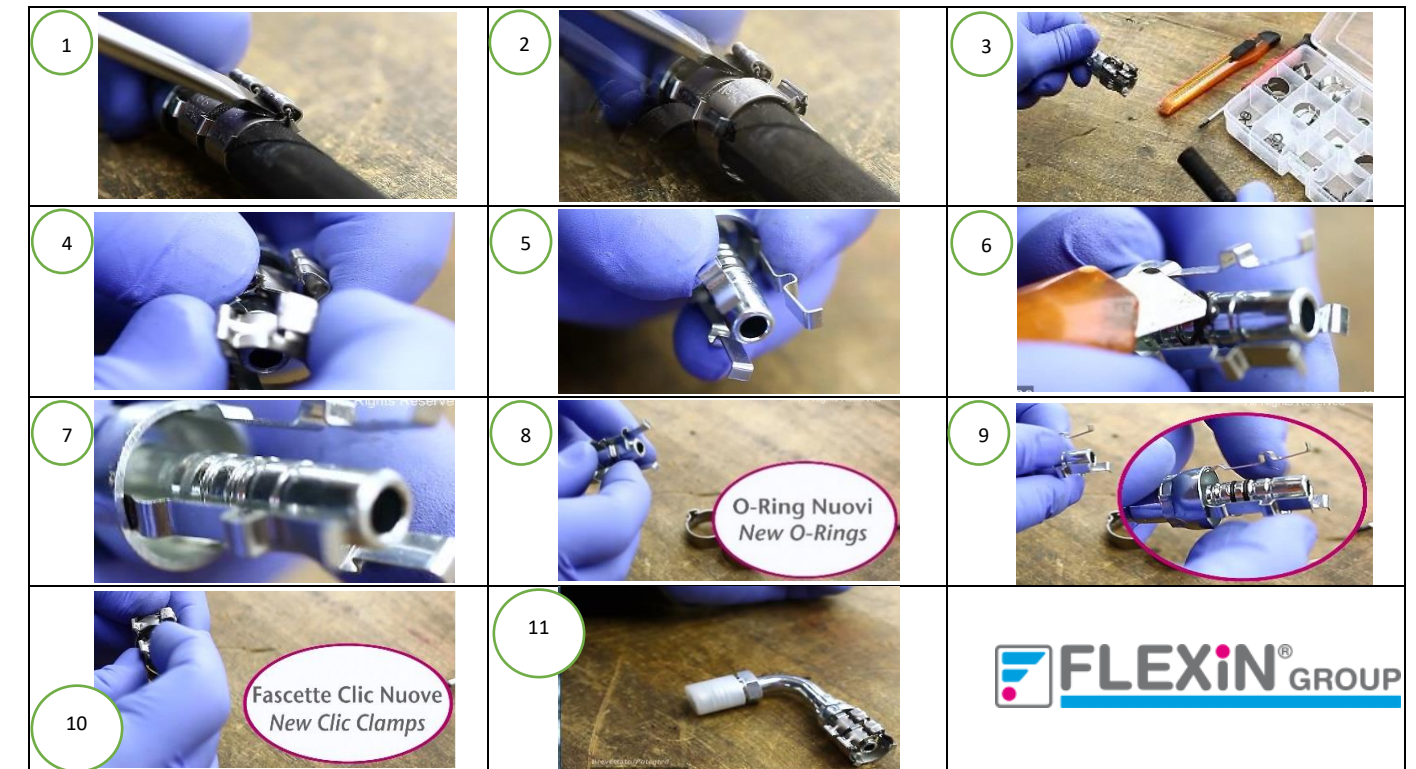

Per il Tutorial Completo Contattare: [info@flexingroup.com](mailto:info@flexingroup.com)  
For a Complete Tutorial Please Contact: [info@flexingroup.com](mailto:info@flexingroup.com)